

D Courses down the river from the Locust to the Whiteoak.

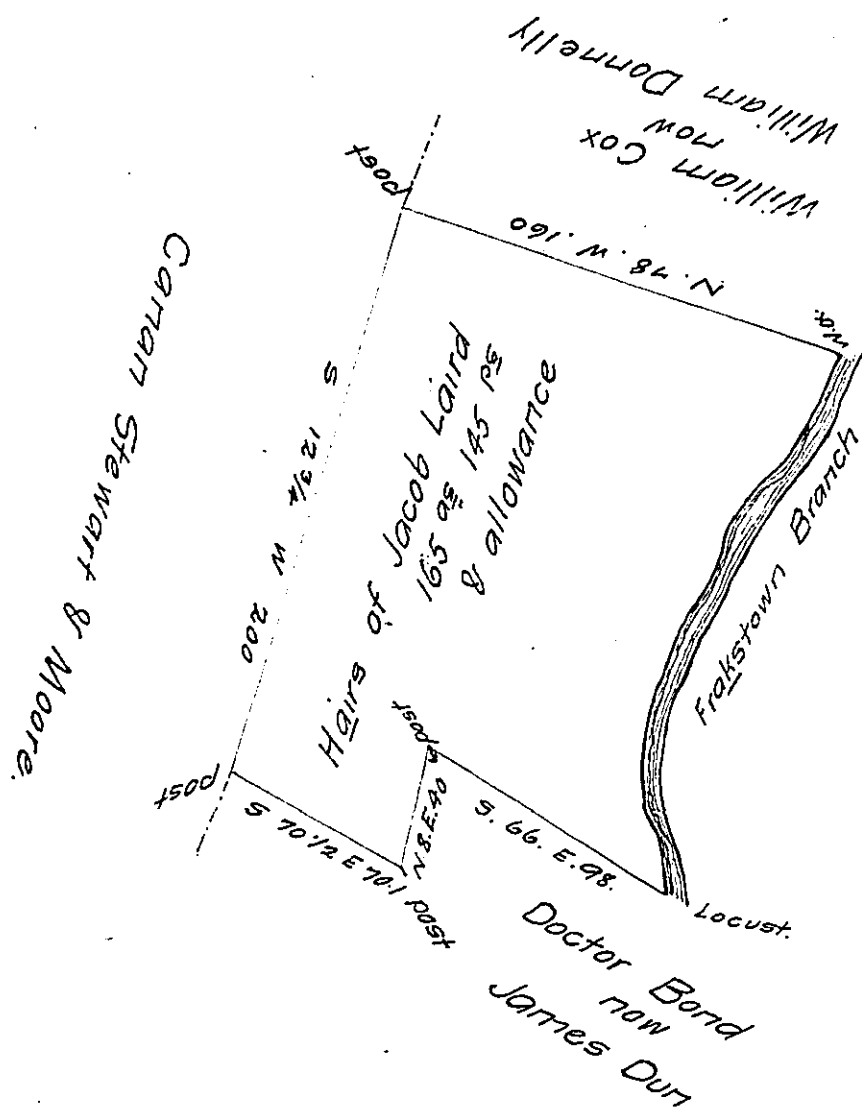

N	14 1/2	W	48
N	9	E	9
N	13	E	9 1/2
N	2	E	7 1/2
N	17	E	24
N	23	E	23
N	24	E	7 1/2
N	13	E	15
N	29	E	18

Situate in Morris Township Huntingdon County  
 Containing one hundred and sixty five acres and one hundred and forty five perches and allowance surveyed September 26<sup>th</sup> 1810 On a Warrant Granted Jacob Laird dated March 22<sup>nd</sup> 1785

Jn<sup>r</sup> Morrison, D.S.

Andrew Porter Esq<sup>r</sup> }  
 Surveyor General }

IN TESTIMONY that the above is a copy of the original remaining on file in the Department of Internal Affairs of Pennsylvania, made conformably to an Act of Assembly approved the 16th day of February, 1833, I have hereunto set my Hand and caused the Seal of said Department to be affixed at Harrisburg, this 25<sup>th</sup> day of August 1905

*Isaac P. Morrison*  
 Secretary of Internal Affairs.